

Panel Mount Type DD

Bi-Lobe®

■ Dual Row Panel Mount (Type DD)

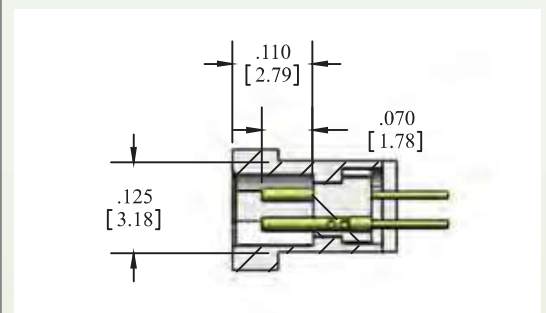
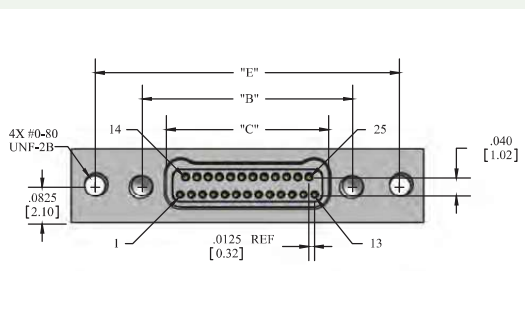
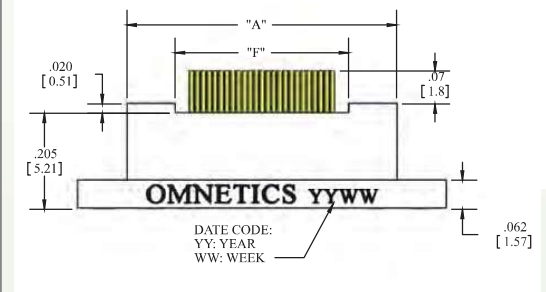
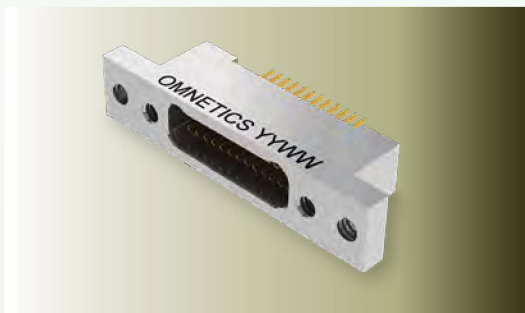
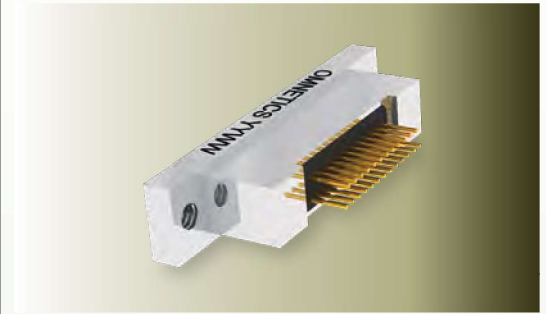
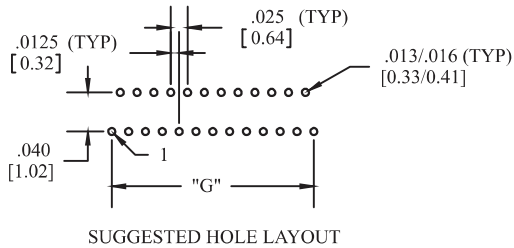

■ English (IN)

■ Metric (mm)

CONTACTS	"A"	"B"	"C"	"D"	"E"	"F"	"G"	"A"	"B"	"C"	"D"	"E"	"F"	"G"
9	0.375	0.270	0.163	0.585	0.480	0.170	0.100	9.53	6.86	4.14	14.86	12.19	4.32	2.54
15	0.450	0.345	0.238	0.660	0.555	0.245	0.175	11.43	8.76	6.05	16.76	14.10	6.22	4.45
21	0.525	0.420	0.313	0.735	0.630	0.320	0.250	13.34	10.67	7.95	18.67	16.00	8.13	6.35
25	0.575	0.470	0.363	0.785	0.680	0.370	0.300	14.61	11.94	9.22	19.94	17.27	9.40	7.62
31	0.650	0.545	0.438	0.860	0.755	0.445	0.375	16.51	13.84	11.13	21.84	19.18	11.30	9.53
37	0.725	0.620	0.513	0.935	0.830	0.520	0.450	18.42	15.75	13.03	23.75	21.08	13.21	11.43
51	0.900	0.795	0.688	1.110	1.005	0.695	0.625	22.86	20.19	17.48	28.19	25.53	17.65	15.88
65	1.075	0.970	0.863	1.285	1.180	0.870	0.800	27.31	24.64	21.92	32.64	29.97	22.10	20.32